

Download the App



<https://bit.ly/oilapp>



<https://bit.ly/oaplay>

Download the Oil Analysis app from the App Store or Google Play. After installation, use your WebCheck credentials to login to the app.

Take your oil samples



1

Remove the sample label from the sample form and stick to the sample bottle.



2

Take the oil sample as you normally would and re-cap the sample bottle.



3

Ensure that the cap is securely tightened and wipe any excess oil from the sample bottle.

Complete sample submission with the asset tag booklet & the app



4

Using the app, scan the QR code of the machine the sample was taken from. Remove the tracking label from the sample form and stick to the asset log booklet.



5

Next, scan the sample label, and complete the sample information and submit the sample.



1

Login to the app using your WebCheck credentials. The app will cache your machines.

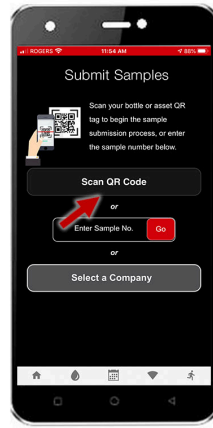

2

Once logged in, click on the "Scan QR Code" button.



3

Locate the machine that was sampled in the asset tag booklet and scan that QR code.

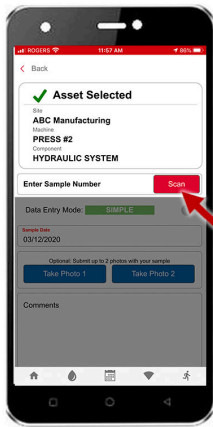

4

The asset is selected & sample submission screen is loaded. Click the "Scan" button.



5

Scan the sample bottle label from your oil sample for the selected machine.

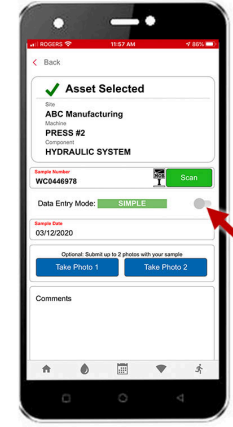

6

The sample is now linked to the machine. Use the "SIMPLE" data entry mode to add info.

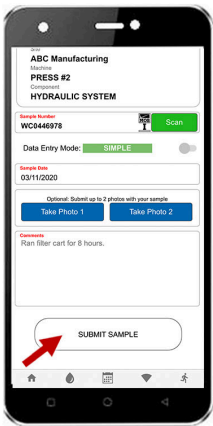

7

Select the sample date, take any pictures you want, add a comment if desired, then click the "submit sample" button

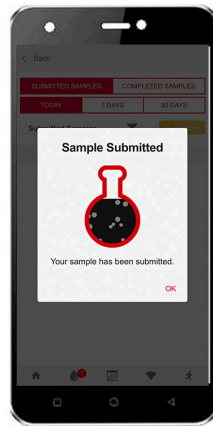

8

The sample info has been submitted to the laboratory where the QR code will be scanned, and the sample information automatically retrieved.



9

Submitted samples are listed. To update a samples info slide left. To delete a sample slide right.

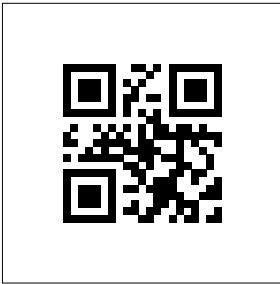

EID:2658776

Area
C1 RULer Conductivity

Machine ID
NUOVO-PIGNONE C1 Turbine/Compressors

Component
Turbine

Make/Model
NUOVO-PIGNONE



Latest sample tracking label



EID:2647168

Area
C3 RULer Conductivity

Machine ID
NUOVO-PIGNONE C3 Compressor

Component
Compressor

Make/Model
NUOVO-PIGNONE 506



Latest sample tracking label



EID:2647167

Area
E1 RULer Conductivity

Machine ID
NUOVO-PIGNONE E1 Pignone Frame 5-70001-TB

Component
Turbine

Make/Model
NUOVO-PIGNONE FRAME 5



Latest sample tracking label

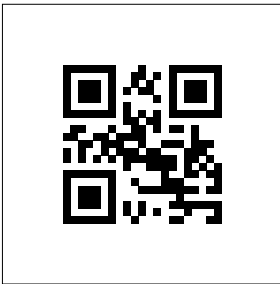

EID:2647170

Area
E2 RULer Conductivity

Machine ID
NUOVO-PIGNONE E2 PGT 10-70002-Turbine/Generator

Component
Genset

Make/Model
NUOVO-PIGNONE PGT-10



Latest sample tracking label

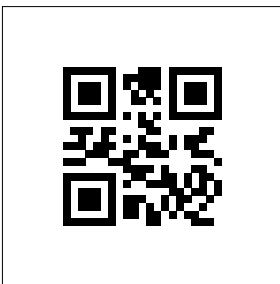

EID:2675257

Area
S1 RULer Conductivity

Machine ID
SOLAR S1 SOLAR TURBINE

Component
Turbine

Make/Model
SOLAR TAURUS 60



Latest sample tracking label



EID:2675253

Area

S2 RULer Conductivity

Machine ID

SOLAR S2 SOLAR TURBINE

Component

Turbine

Make/Model

SOLAR TAURUS 60



*Latest sample
tracking label*