

Download the App



<https://bit.ly/oilapp>



<https://bit.ly/oaplay>

Download the Oil Analysis app from the App Store or Google Play. After installation, use your WebCheck credentials to login to the app.

Take your oil samples

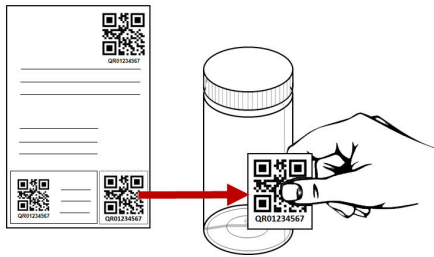

1

Remove the sample label from the sample form and stick to the sample bottle.



2

Take the oil sample as you normally would and re-cap the sample bottle.



3

Ensure that the cap is securely tightened and wipe any excess oil from the sample bottle.

Complete sample submission with the asset tag booklet & the app



4

Using the app, scan the QR code of the machine the sample was taken from. Remove the tracking label from the sample form and stick to the asset log booklet.



5

Next, scan the sample label, and complete the sample information and submit the sample.



1

Login to the app using your WebCheck credentials. The app will cache your machines.

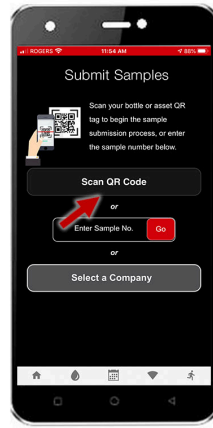

2

Once logged in, click on the "Scan QR Code" button.



3

Locate the machine that was sampled in the asset tag booklet and scan that QR code.



4

The asset is selected & sample submission screen is loaded. Click the "Scan" button.



5

Scan the sample bottle label from your oil sample for the selected machine.



6

The sample is now linked to the machine. Use the "SIMPLE" data entry mode to add info.



7

Select the sample date, take any pictures you want, add a comment if desired, then click the "submit sample" button

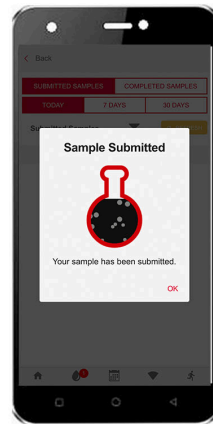

8

The sample info has been submitted to the laboratory where the QR code will be scanned, and the sample information automatically retrieved.



9

Submitted samples are listed. To update a samples info slide left. To delete a sample slide right.

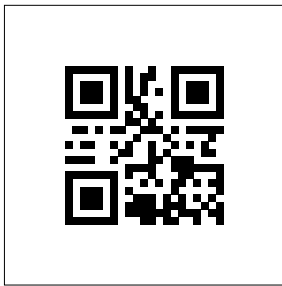

EID:3562022

Area
{unassigned}
Machine ID
1343
Component
Diesel Engine
Make/Model
FREIGHTLINER ROLL OFF



*Latest sample
tracking label*

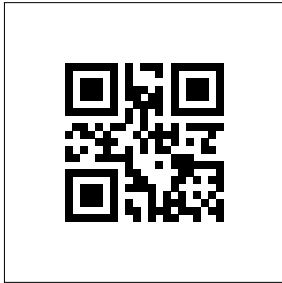

EID:3562023

Area
{unassigned}
Machine ID
1347
Component
Diesel Engine
Make/Model
MACK ROLL OFF TRUCK



*Latest sample
tracking label*

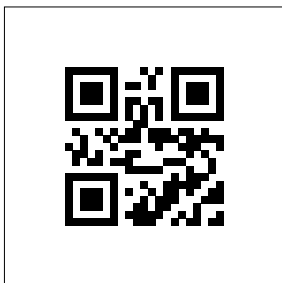

EID:3562024

Area
{unassigned}
Machine ID
1349
Component
Diesel Engine
Make/Model
KENWORTH Roll Off



*Latest sample
tracking label*

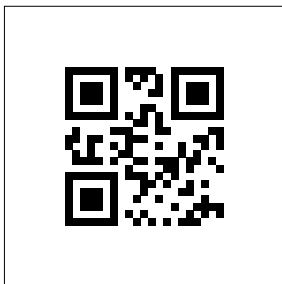

EID:3562025

Area
{unassigned}
Machine ID
1351
Component
Diesel Engine
Make/Model
FREIGHTLINER 114SD



*Latest sample
tracking label*

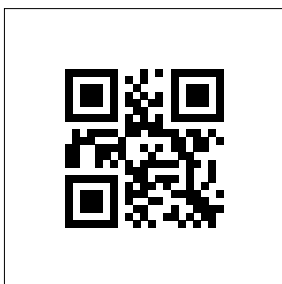

EID:3562026

Area
{unassigned}
Machine ID
1354
Component
Diesel Engine
Make/Model
INTERNATIONAL REAR LOAD TRASH



*Latest sample
tracking label*

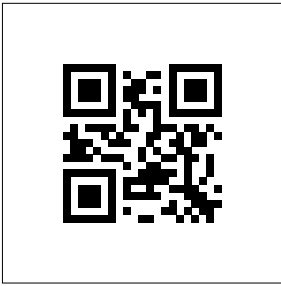

EID:3562027

Area
{unassigned}
Machine ID
1355
Component
Diesel Engine
Make/Model
INTERNATIONAL 7400



*Latest sample
tracking label*



EID:3562028

Area
{unassigned}
Machine ID
1361
Component
Diesel Engine
Make/Model
MACK GR64F



*Latest sample
tracking label*

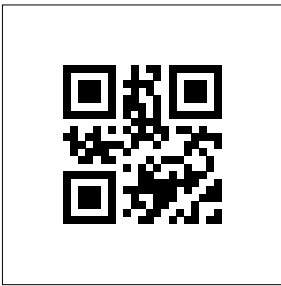

EID:3562029

Area
{unassigned}
Machine ID
1375
Component
Diesel Engine
Make/Model
WESTERN STAR 4700SF



*Latest sample
tracking label*

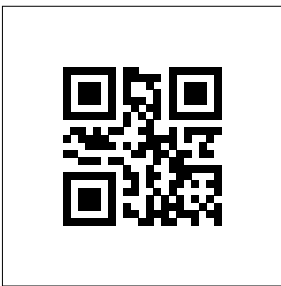

EID:3562217

Area
{unassigned}
Machine ID
420009-1310
Component
Diesel Engine
Make/Model
INTERNATIONAL HX620



*Latest sample
tracking label*

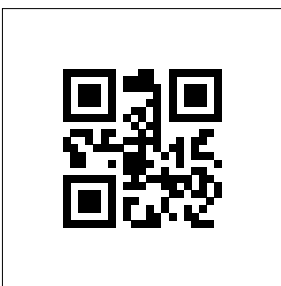

EID:3716468

Area
{unassigned}
Machine ID
425024
Component
Diesel Engine
Make/Model
FREIGHTLINER 114SD



*Latest sample
tracking label*

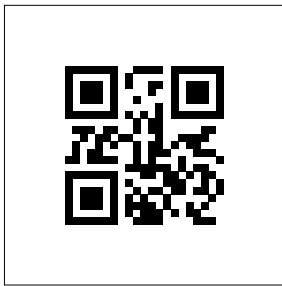

EID:3700374

Area
{unassigned}
Machine ID
522011/847
Component
Diesel Engine
Make/Model
KENWORTH



*Latest sample
tracking label*

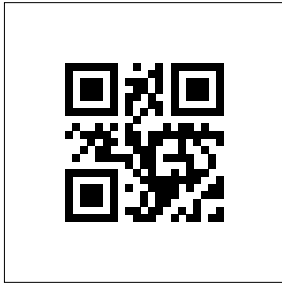

EID:3562216

Area
{unassigned}
Machine ID
727025-594
Component
Diesel Engine
Make/Model
MACK REAR LOAD



*Latest sample
tracking label*

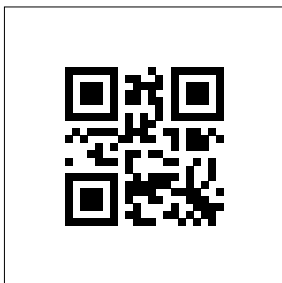

EID:3562218

Area
{unassigned}
Machine ID
821017-866
Component
Diesel Engine
Make/Model
FREIGHTLINER SIDE LOAD



*Latest sample
tracking label*

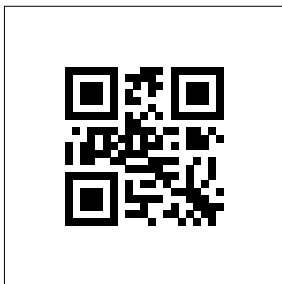

EID:3562219

Area
{unassigned}
Machine ID
928023
Component
Diesel Engine
Make/Model
MACK PACKER FRONT LOADER



*Latest sample
tracking label*

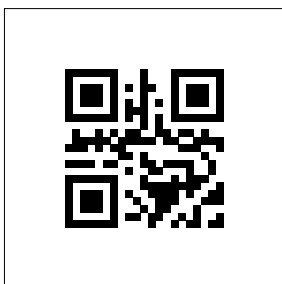

EID:3562220

Area
{unassigned}
Machine ID
928031
Component
Diesel Engine
Make/Model
MACK FRONT LOAD RES.



*Latest sample
tracking label*

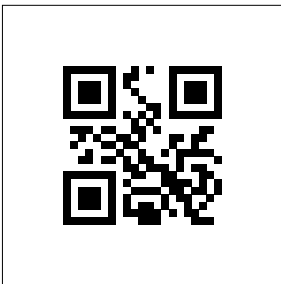

EID:3632901

Area
{unassigned}
Machine ID
98031-1130
Component
Diesel Engine
Make/Model

